

A RESOLUTION AMENDING KING COUNTY DISTRICTING (ZONING) RESOLUTION NO. 18801, AS AMENDED, BY AMENDING THE DISTRICT (ZONING) MAP THEREOF RECLASSIFYING CERTAIN PROPERTY THEREON.

WHEREAS WALTER SCHWEIN GRUBER has petitioned King County, requesting reclassification of property described in said petition and all legal requirements have been performed; and

WHEREAS, the King County Planning Department has transmitted to the Board of County Commissioners King County, Washington a copy of the King County Planning Agency's findings and action recommending that the District (Zoning) Map be amended as shown and for the reasons stated therein; and

NOW THEREFORE BE IT RESOLVED that the Board of County Commissioners does hereby adopt the findings and recommendations of the Planning Agency as its own and does hereby reclassify certain property to R-3 as shown hereon and legally described herein which lies within Section 9 Township 23 Range 8 E.W.M. on Area Map Hwy2 a part of the District (Zoning) Map.

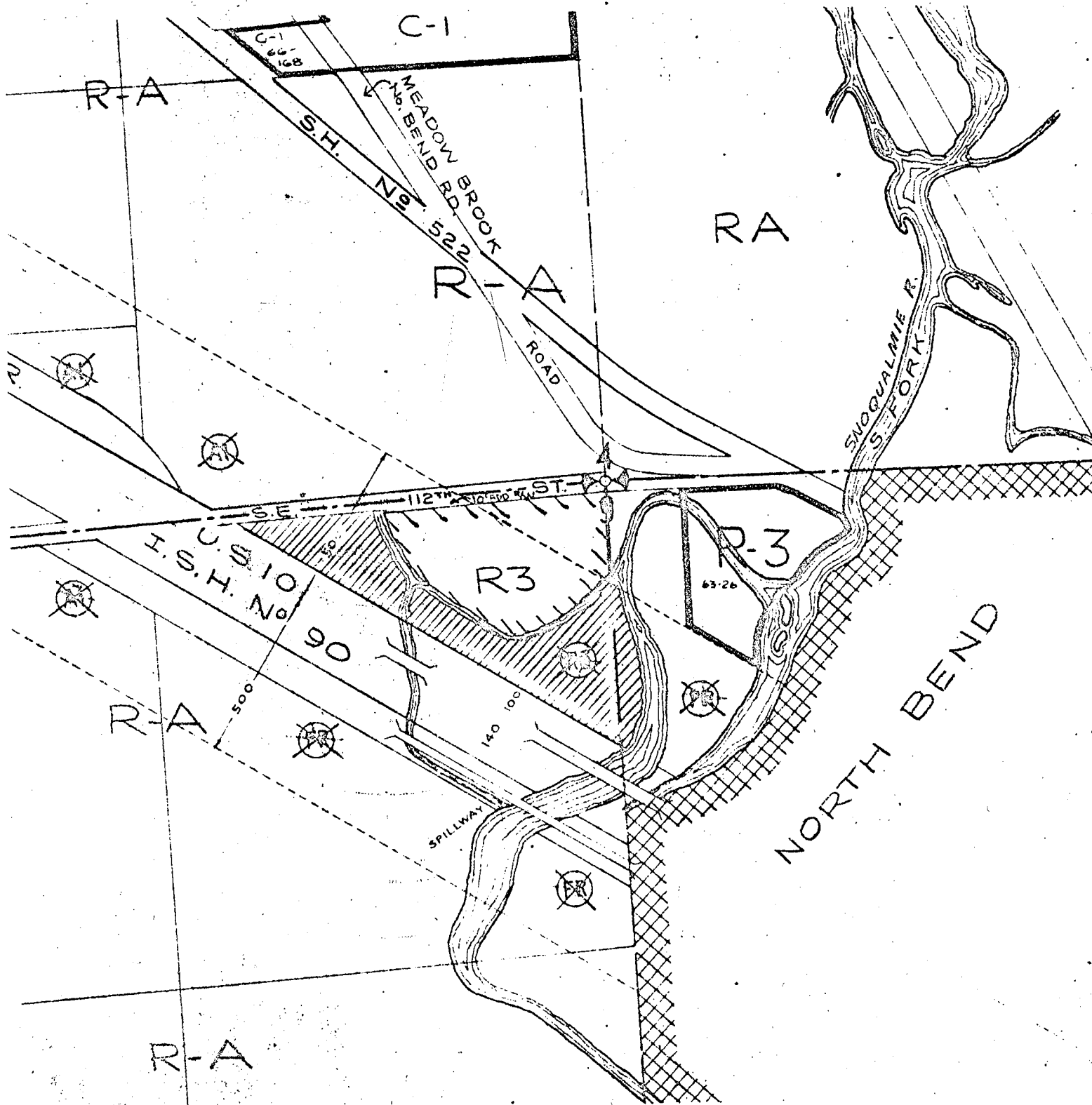

AREA RECLASSIFIED BY THIS RESOLUTION

